



Safety Notice

● Please read this manual carefully before using the tool. For safe operation, please comply with each item.

1. For safe operation, please comply with each item. Carefully inspect the tool and familiarize yourself with how it operates.
2. Wear safety glasses and earplugs.
3. It is recommended to wear a dust mask and gloves
4. Wear appropriate clothing and safety shoes. Avoid loose clothing and keep neckties, long hair and jewelry away from the tool.

*Before using the tool, check the air hose and connections for damage.

*When replacing accessories or tools, always remove the tool from the hose.

*Fix the workpiece with a clamp or suitable holding device.

*Keep others away from the work area.

*Tool repairs may only be performed by qualified technicians.

*Continued vibrations, repetitive movements, and awkward postures can harm your body.

● About compressed air supply

1. Pour a few drops of spindle oil into the pneumatic tool inlet before use.
2. Under load, the required air pressure of the pneumatic tool <a> is decided according to its structure.
3. Clean the air filter <d> from time to time.
4. If the air pressure is too low, the performance of the pneumatic tool will be degraded. Conversely, if it is too high, excessive wear will occur.
5. To prevent rust and reduce wear, remove dust from the pneumatic tool <a> after use and apply oil.
6. Store the pneumatic tool in a clean and dry place.
7. Make sure compressor air is clean and dry.
8. Evacuate the drain daily with an air filter <d> and compressor <h>.
9. Use only original accessories and tools.
10. Proper and regular lubrication is very important for pneumatic tools. Failure to lubricate will significantly reduce tool performance and life.
11. Rotor blades should be checked regularly by a qualified technician and replaced as appropriate.
12. Other moving parts should also be maintained as necessary.

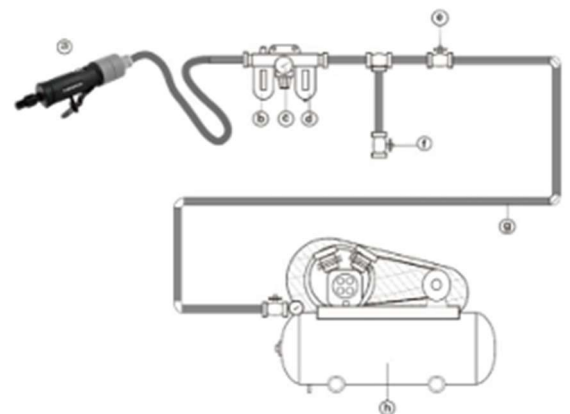

- | | |
|----|------------------------|
| a. | Air tools |
| b. | Euler |
| c. | Regulator |
| d. | Filter/Water Separator |
| e. | Shut-off valve |
| f. | Pressure relief valve |
| g. | Piping |
| h. | Compressor |



Other recommendations

Recommended minimum pipe diameter = 10 mm (3/8 in); recommended hose inner diameter is 6.35 mm and length within 8 m

Proper air pressure = 0.49-0.69 Mpa (5.7kgf / cm²)

● Notes on operation

Work environment

1. Pneumatic tools are prohibited from using in potentially explosive environments.
2. It is recommended that the pneumatic tool be used on firm footing.
3. It is highly recommended to use pneumatic tools in a well-ventilated area.
4. Slipping, tripping and falling can be a major cause of serious injury. It is strongly recommended that the work area be thoroughly tidy and cleaned before operating the pneumatic tool.

Oil injection

Proper oil injection is very important for pneumatic tools. Failure to lubricate will significantly reduce tool performance and life.

Note: Pneumatic tools require lubrication both before and after use.

How to inject oil into motor

- a. Remove the pneumatic tool from the hose.
- b. Inject 3-5cc of oil from the air inlet. Oil reaches the motor by pressing the lever.
- c. Connect the tool to the hose, cover the exhaust with a towel and press the trigger to activate the pneumatic tool.
- d. If the pneumatic tool is idled for 5 to 10 seconds, dirt etc. will be discharged by the air pressure.